

- High filling efficiency
- Large inlet size in relation to rotor volume
- Minimum air leakage
- Explosion proof models available up to 10 bar g
- Customised solutions
- Body with one round and one square flange
- Round flange drilled in accordance with PN 10, ANSI 150 lbs or JIS
- Can be used as a transition piece from round to square or vice versa
- Versions conforming to ATEX 94/9/EC available



AML

The AML air lock has been designed by DMN-WESTINGHOUSE for many applications in the metering and pneumatic conveying of products in powder and granular form. The AML valve can also be used as a transition piece from round to square or vice versa.

An extensive and flexible range of rotary valves is available. Due to the modular design of the valves many different configurations are available, using standard components.

The product line also includes USDA approved models for sanitary use in the food and pharmaceutical industry, the types Dairy and Dairy MZC. These stainless steel valves are easy detachable in a few minutes and meet the highest hygienic standards.

The AML valves are available in 7 consecutive sizes from 100-400, covering a capacity range of the rotor from 0,8 to 58 litre per revolution at 100 % filling.

Drive options include chain, direct, air and hydraulic drive.

Product information

The valves are available in two materials of construction: cast iron and stainless steel. The cast iron valves are also available nickel or chrome plated or tungsten coated.

The standard rotor has 9 blades. Various rotor configurations are optionally available, such as adjustable blades, reduced capacity, scalloped, end disc, etc.

The valve has outboard ball bearings, and the shaft sealing is by means of gland packing, with the option of air purge.

The standard models are suitable for products up to a temperature of 150 °C and a maximum pressure differential of 2 bar. Special configurations are available to accommodate temperatures between -200 °C and +900 °C. Configurations pressure shock resistant up to 10 bar g and explosion proof models are also available.

All models offer optimum venting through the large vent holes, which can be drilled to order.

AML

Technical modifications are possible, dimensions in mm AML.M.01.00.F

Maatschets AML
Dimensions AML
Maßskizze AML
Dimensions d'écluse AML

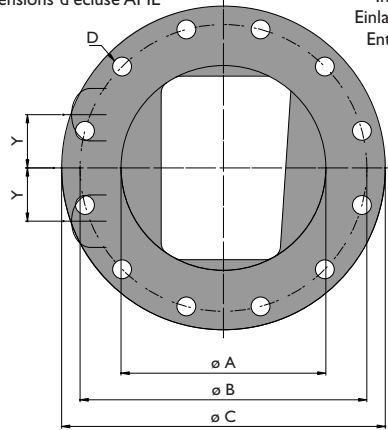

Inlaat of uitlaat
Inlet or outlet
Einlauf oder Auslauf
Entrée ou sortie

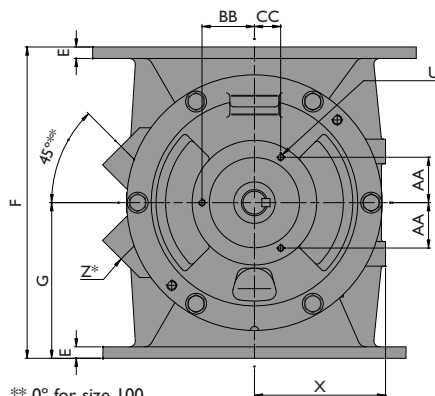
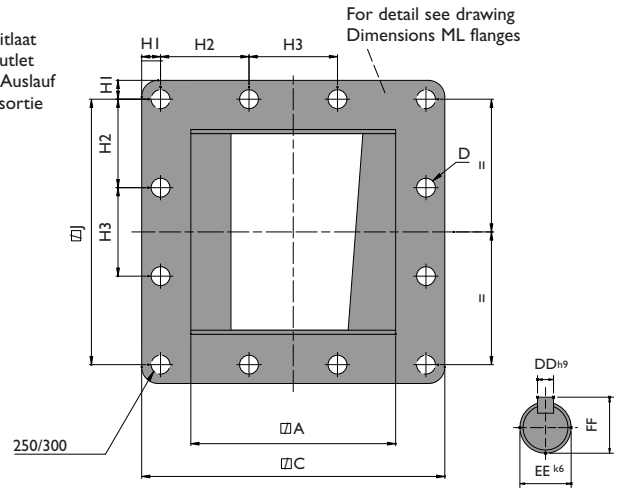

** 0° for size 100

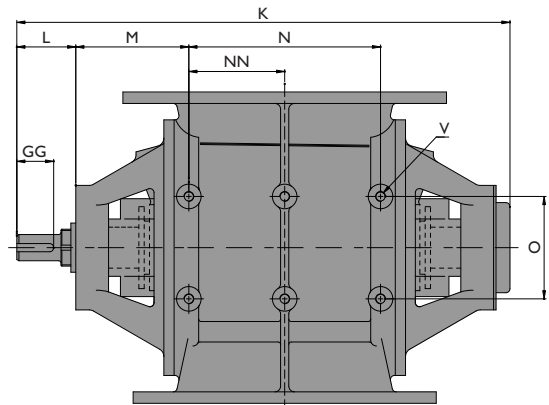

DMN-WESTINGHOUSE have been designing and manufacturing rotary valves, diverter valves and other related components for the bulk solids handling industry for more than 30 years. Offering tailor made solutions for chemical, food, plastics and pharmaceutical industries, DMN-WESTINGHOUSE products are distributed worldwide. Besides an extensive range of standard components, we supply USDA accredited sanitary versions and ATEX approved explosion-proof models. An extensive network of subsidiaries, distributors and representatives ensures a high level of service and support all over the world.

Type AML	Ltr/rev	ØA	∇A	ØB	ØC	∇C	D	E	F	G	H1	H2	H3	∇J	K	L	M	N	NN
100	0,8	100	100	170	210	175	4xØ18	11	170	85	20	135	-	135	328	52	84	90	-
150	2,5	150	150	240	285	267	8xØ23	11	275	138	88	92	-	222	484	60	127	146	73
200	5,5	200	200	295	340	320	8xØ23	14	325	163	104	113	-	273	524	60	125	190	95
250	10,5	250	250	350	395	370	12xØ23	14	380	190	23	108	108	342	609	72	138	234	117
300	19	300	300	400	483	445	12xØ23	21	450	225	31	128	128	384	659	72	138	284	142
350	34	350	350	460	530	530	16xØ23	21	540	270	109	104	104	460	763	74	150	360	180
400	58	400	400	515	595	595	16xØ26	26	660	330	125	115	115	515	833	74	155	420	210

Type AML	O	U	V	X	Y	Z*	AA	BB	CC	DD	EE	FF	GG
100	75	3xM6	4xM10	90	-	-	-	35	35	8	25	28	43
150	100	3xM6	4xM10	110	40	3/4"	37,1	52,5	37,1	8	30	33	36
200	100	3xM6	6xM10	130	53	1"	37,1	52,5	37,1	8	30	33	36
250	125	3xM8	6xM12	160	65	1 1/4"	55,4	64	32	10	32	35	44
300	125	3xM8	6xM12	190	75	1 1/4"	55,4	64	32	10	32	35	44
350	125	3xM10	6xM12	225	95	1 1/2"	73,6	85	42,5	10	38	41	45
400	125	3xM10	6xM12	270	112	1 1/2"	73,6	85	42,5	10	38	41	45

* Standaard niet voorgedrukt
Standard not pre-drilled
Standard nicht gebohrt
Standard pas percé

Head Office:
DMN Machinefabriek Noordwykerhout BV
PO Box 6, NL - 2210 AA Noordwijkerhout, Holland
Tel. +31 252 361 800
Fax +31 252 375 972/934
dmn@dmn-nwh.nl

DMN Incorporated
3895 South Perkins Road, Suite 8
Memphis, TN 38118, USA
Tel. +1 901 360 1537
Fax +1 901 360 0348
dmnfo@dmn-inc.com

DMN Schüttguttechnik GmbH
Rütgersstrasse 8
D-21244 Buchholz i.d. Ndh, Germany
Tel. +49 4181 931 40
Fax +49 4181 931 490
dmn@dmn-schuettingtechnik.de

DMN UK Ltd
Unit 1&2, Harris Road,
Porte Marsh Industrial Estate
Calne, Wiltshire, SN11 9PT, UK
Tel. +44 1249 818 400
Fax +44 1249 818 410
dmn@dmnuk.com

DMN France SAS
65, rue Charles de Gaulle
91330 Yerres, France
Tel: +33 1 69 49 85 70
Fax: +33 1 69 49 85 79
dmnfrance@wanadoo.fr

© DMN - HOLLAND - 07/06



www.dmn.info

DMN
WESTINGHOUSE